

## Building Sketch

Borrower/Client	N/A		
Property Address	1742 S Euclid Ave		
City	Wichita	County	Sedgwick
		State	KS
		Zip Code	67213

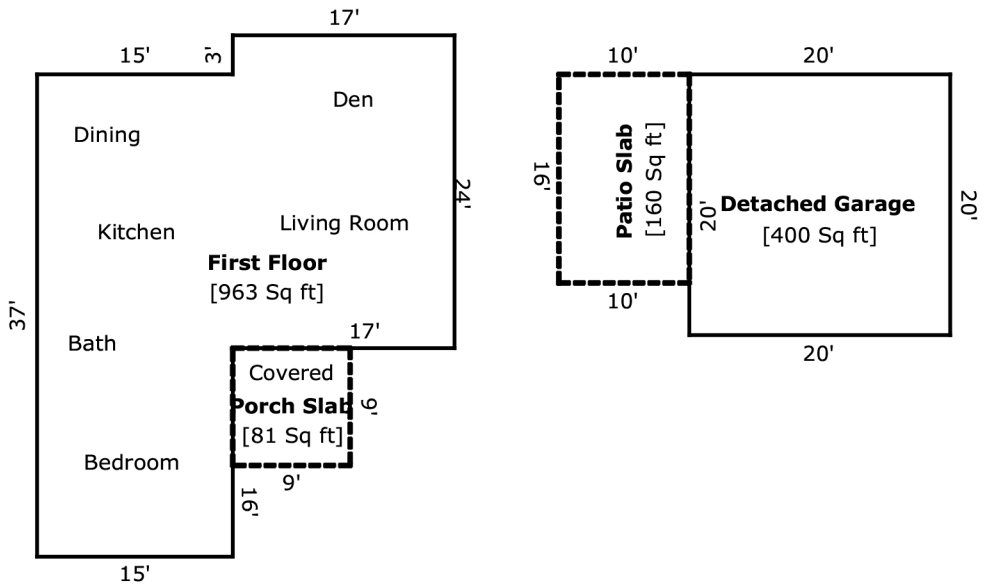

TOTAL Sketch by a la mode, inc.

### Area Calculations Summary

Living Area	Calculation Details	
First Floor	963 Sq ft	$24 \times 17 = 408$ $37 \times 15 = 555$
<b>Total Living Area (Rounded):</b>	<b>963 Sq ft</b>	
Non-living Area		
Detached Garage	400 Sq ft	$20 \times 20 = 400$
Porch Slab	81 Sq ft	$9 \times 9 = 81$
Patio Slab	160 Sq ft	$10 \times 16 = 160$